

J o h n

141
(No Patent)
1495
2-178

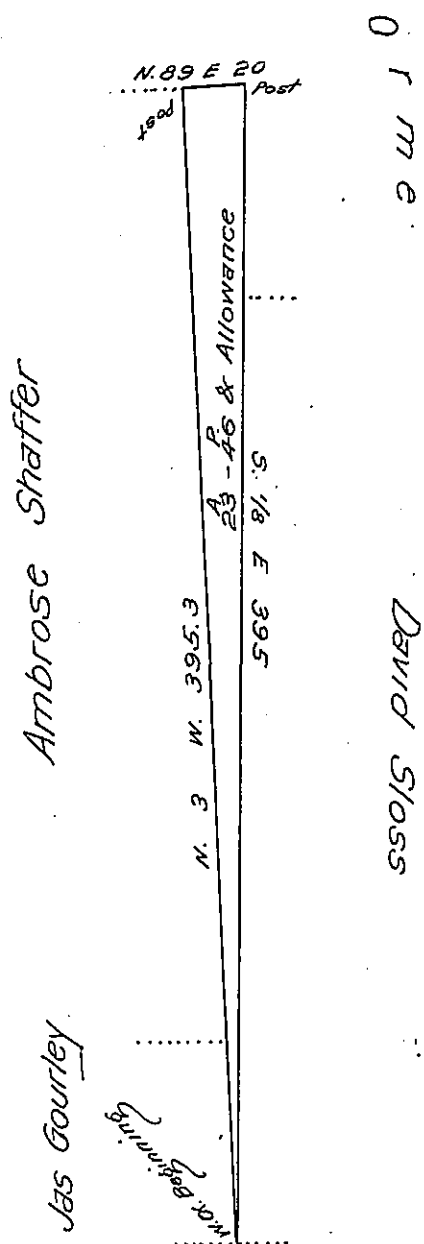

The above is a Draught of a Survey made May 15th 1838. in pursuance of a warrant granted to John Orme & Ann Orme his wife for 40 Acres. Dated April 16th 1838. Containing twenty three Acres. & 46 perches. & Allowance of six per Cent. situate in Pine Township Allegheny County - Note Ambrose Shaffer claims up to David Sloss he says he bought it of H Sweny. but neither Sweny's Patent nor Shaffers Deed will cover it, they have a surplus both in distance and quantity left. and the course of shaffers Deed is N 3/4 W. being one fourth of a Degree more on Shaffer than where it is run

John Taylor, Esq
Surveyor General

Stephen Woods, D.S.

IN TESTIMONY that the above is a copy of the original remaining on file in the Department of Internal Affairs of Pennsylvania, made conformably to an Act of Assembly approved the 16th day of February, 1833, I have hereunto set my Hand and caused the Seal of said Department to be affixed at Harrisburg, this twenty-ninth day of September 1906

Loac D Brown
Secretary of Internal Affairs.